

EGS380-6	EGS380BS-6
Open Type	Bonnet & Soundproof Type



SPECIFICATIONS

ENGINE

- Model : Komatsu SAA6D125-P400
- Rated Output, Net (With Fan)

Engine Speed		1,500 rpm (50Hz)	
Rating		Prime	Standby
Output	HP	400	440
	kW	298	328

- Fuel Consumption (Approximately)

Hz	Load, %	25%	50%	75%	100 %
50	Generator, kVA	88	175	263	350
	Fuel, Liter/H	22	34	57	75

RATED OUTPUT

Frequency		50Hz (1,500 rpm)	
Rating		Prime	Standby
Rated Output	kVA	350	385
	kW	280	308
Rated Voltage *		380/220V, 400/231V, 415/240V	

* Rated Voltage : Line to Line / Line to Neutral

DESIGN FEATURES

● **Komatsu Diesel Engine**

- High Quality, Reliability and Durability
- High Output and Low Fuel Consumption
- Light Weight and Compact Design
- Low Noise and Low Vibration

● **Proven Performance & Technology**

Komatsu EGS series diesel generator sets, the combination of Komatsu engine and reliable alternator, are manufactured under strict quality control standards.

● **Generator Control Panel**

EGS series generator sets have a compact and intelligent generator control module, which provides all the safety protections and its window displays both the AC and DC digital measurements.

- Easy Maintenance : Minimize control components and wirings
- High Reliability : 16-bit microprocessor technology in printed circuit board
- Easy Recognition: clear icon based language free can identify engine status more directly
- Built-in AMF Function: Auto Start / Stop when mains failure occurred

The control panel will automatically shut down the generator set when fault occurred, then indicating the failure and providing audible alarm.

CONDITIONS & DEFINITIONS

● **Prime Power Rating :**

Applicable for supplying electric power with varying load of an unlimited number of hour per year or 70% constant load.

This rating is set in accordance with ISO 8528

● **Standby Power Rating :**

Applicable for supplying emergency power at variable loads in areas where reliable utility is available. The operating hours shall not exceed one hour in 12 hours operation.

This rating is set in accordance with ISO 3026-1, din 6271 and BS 5514

Type ----- 4-stroke Cycle, Water Cooled, Overhead Valve, Direct Injection

Speed Regulation ----- Droop within 5% (Mechanical Governor)

Aspiration ----- Turbocharged Air to Air Aftercooled

Cylinder Arrangement -- 6 in-line

Bore x Stroke ----- 125 mm x 150 mm

Piston Displacement --- 11.04 liters

Starting Method ----- Electric Motor, 24V - 7.5 kW x 1

Charging Alternator ----- DC24V-35A (Brushless)

Lubrication ----- Forced Lubrication by Gear Pump

Lube Oil Filter ----- Full-flow, Spin On/Off Type Cartridge

Fuel Oil Filter ----- Spin On/Off Type Cartridge

Air Cleaner ----- Dry, Cyclopac 2 Stages of Paper Element with Dust Evacuator Valve

Oil Capacity ----- Oil Pan (H/L) : 58/38 liters
System Total : 62 liters

Coolant Capacity ----- Engine : 19 liters
Radiator : 12.6 liters

ALTERNATOR

Rated Power Factor ----- 0.8

Excitation ----- Self Excited, Brushless

Cooling ----- Self Ventilation

Automatic Voltage Regulator Equipped in Alternator

Number of Pole ----- 4

Rotor Supporting Type ----- Single Bearing

Degree of Protection ----- Screen Protected (IP22)

Number of Wire ----- 3-Phase / 4-Wires

Insulation Class ----- Class H

Insulation Resistance ----- More than 3 Mohms

Voltage Regulation ----- ± 1.0 %

Total Harmonic, TGH / THC - < 4%

Waveform, NEMA = TIP ----- < 50

Waveform, IEC = THF ----- < 2%

APPLICABLE CONDITIONS

Ambient Temperature : 0 ~ 40 °C

Altitude : Maximum 1,000 m

Ambient Humidity : Under 80 %

DIMENSIONS

Unit : mm

EGS380-6 Open Type

Dry Weight : Approx. 3000 kg

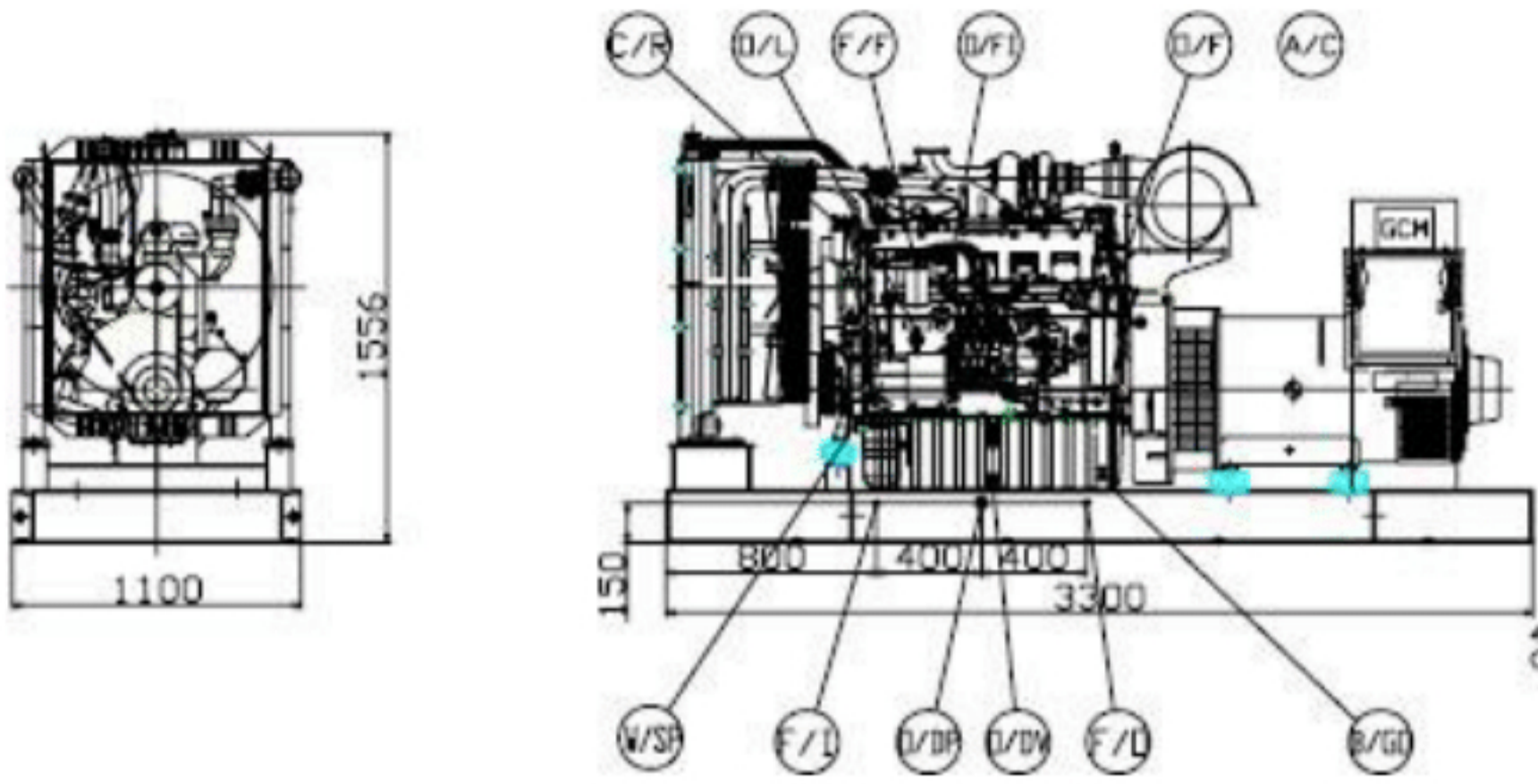

3300×1100×1560

EGS380BS-6 Bonnet and Soundproof Type

Dry Weight : Approx. 4730 kg

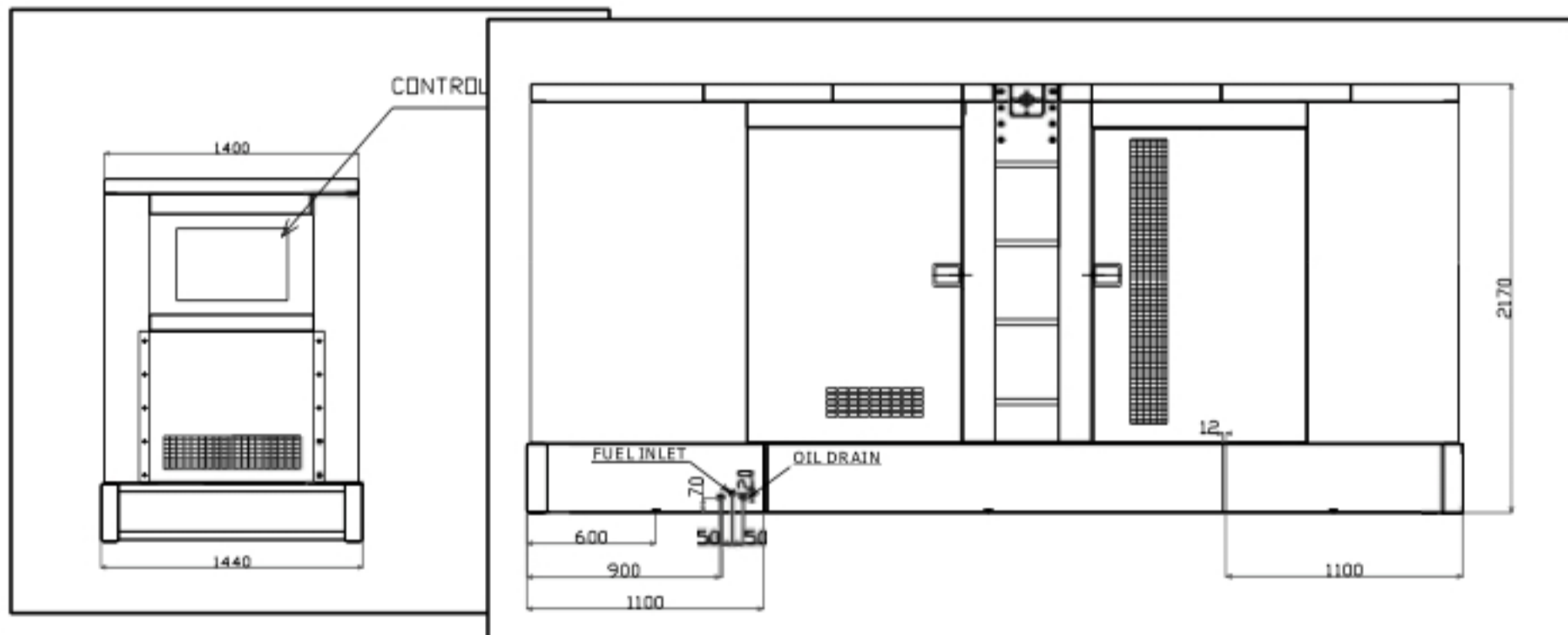

4340×1440×2170

STANDARD / OPTIONAL ACCESSORIES

● : Standard ○ : Optional

Generator Set			
●	Main components mounted on the skid base. (Engine, Alternator, MCCB, Control Panel and Lead Acid Battery)	●	
●	Rated Voltage : AC 200V or 220V class	○	
Engine			
●	Engine Stop Method : Energized in run mode (Electric Stop Solenoid is mounted to the Fuel Lever)	●	
●	Muffler	Industrial (non-bonnet type)	●
		Residential (bonnet type)	●
		Residential (non-bonnet type)	○
●	Corrosion Resistor and Water Separator	●	
●	Engine Speed Control System	Fixed Lever Type	●
		Electronic Speed Controller and Actuator	○
●	Cold Starting Aid	○	
Alternator			
●	Anti-condensation Heater	○	
Control Components			
●	Generator Control Module	Automatic Start / Stop Type	●
		Mode Switch : OFF / AUTO / MAN	
		Built-in AC and DA Digital Measurements	
		Basic Icon for Annunciation	
		Built-in AMF Function	
		Capable for Remote Signal, Monitoring and Control System (Remote Control cable is optional)	
○	Engine Oil Temperature Gauge	○	
○	Analogue Tachometer (Magnetic Pick Up Type)	○	
●	Emergency Stop Push-button	●	
●	MCCB	Shunt Trip Coil	●
		Under Voltage Trip Type	○
		Motorized Breaker	○
○	Voltage Trimmer (Potentiometer)	○	
○	Speed Trimmer (Potentiometer)	○	
○	Battery Charger	○	
Fuel Tank			
○	Skid Base Tank Type(Open Type)	○	
○	Self-Standing Tank Type	○	
Control System			
○	Synchronizing Panel	○	
○	Self-Standing ATS Panel	○	

Materials and specifications are subject to be changed without notice.

KOMATSU

